

FOR SALE

RESIDENTIAL - CONDOMINIUM 657SQFT (61SQM) / CALL FOR PRICE!

+65 9222 4455



2 - Bedroom Premium

TYPE B5(b)

01 424-1 (507 sqft)
Bk 2: #25-01 to #23-01
#25-01 to #35-01

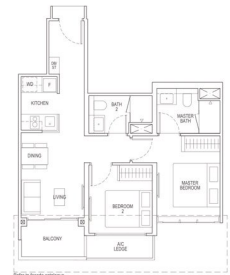

RESIDENTIAL - CONDOMINIUM

IRWELL HILL, IRWELL BANK ROAD, ORCHARD,
RIVER VALLEY, SINGAPORE 239588

- LISTING ID: SGLD41652964
- TENURE: LEASEHOLD 99
- TITLE: N/A
- SIZE BUILT-UP: 657SQFT (61SQM)
- SIZE LAND: 3.160AC (1.279HA)
- NO. OF FLOORS: 36
- FLOOR/LEVEL: N/A - N/A
- BED ROOMS: 2
- BATH ROOMS: 2
- MAIDS ROOMS: N/A
- PARKING SPACES: N/A
- LAYOUT TYPE: OTHER
- FACING: N/A
- VIEWING: OTHER
- SELLING PRICE: **CALL FOR PRICE!**
- COMPLETION YEAR: 2025
- CONDITION: ORIGINAL CONDITION
- FURNISHING: PARTIALLY FURNISHED
- LISTING DATE: APR 16, 2021

IRWELL HILL RESIDENCES

Condominium for Sale: Partially furnished, 2 bedroom, 2 bathroom. Completed in 2025, this unit is in original condition. Tenure: Leasehold 99 Located in Singapore's district D09 near Orchard, River Valley in the area Orchard (Central region).

INTERIOR FACILITIES

- Air-Conditioning
- Balcony
- Internet Connection

OTHER INTERIOR FEATURES

- Cooker Hob/Hood
- Dryer
- Fridge
- Intercom

EXTERIOR FACILITIES

- 24 Hours Security
- Covered Car Park
- Function Room
- Library / Reading Room

VISIT THIS PROPERTY AT: <https://www.ilikenewlaunch.com/property/SGLD41652964>

SIZE KIAT TAN - HUTTONS ASIA PTE LTD

3 Bishan Place #05-01 CPF Bishan Building
D20, 579838, Singapore

+65 9222 4455
WhatsApp Me

kiat@propertysearch.com.sg

<https://www.ilikenewlaunch.com>



Scan QR Code

Huttons® Call for Viewing
The Agency of Choice +65-92224455